



# BrightLock™ Single Mode DFB Laser

## Features

- High power 976nm laser module
- DFB grating enables single frequency (CW mode) operation
- Bragg grating stabilized buried hetero-structure chip

## Applications

- Fiber optic networks and coherent transmission systems
- Fiber laser and amplifier pumping
- Metrology

## Benefits

- Highest performance from fiber lasers due to industry leading brightness and power
- Long term spectral stability from internal grating chip design
- High device reliability via hard solder and CTE-matched mounting technology



Model Number	4809-0000
Center wavelength	976 +/- 1nm
Output Power	150 mW
Operating Current	< 260mA
Operating Voltage	< 1.8 V
Threshold current	< 25 mA
Slope efficiency (@ I <sub>th</sub> )	> 0.7 W/A
Side mode suppression ratio (dB)	> 35dB
dλ/dt	0.08 nm/°C
Slow Axis Divergence (1/e <sup>2</sup> )	42 deg
Fast Axis Divergence (1/e <sup>2</sup> )	62 deg
Cavity Length	1.0 mm
C mount Size	6.9 x 6.4 x 3.6 mm
Chip bonding	p-down

**Warning:** Class 4 Laser. Invisible Laser Radiation – Avoid Eye or Skin Exposure to Direct or Scattered Radiation.

**BRIGHTNESS and POWER**  
*Breaking Performance Barriers through Semiconductor Laser Innovation*

**QPC Lasers, Inc.**

15632 Roxford Street • Sylmar, CA 91342 • Phone: +1 (818) 986-0000 • Fax: +1 (818) 698-0428

www.QPClasers.com • email: info@QPClasers.com



QPC is ISO 9001:2000 certified



# BrightLock™ Single Mode DFB Laser

## C-Mount

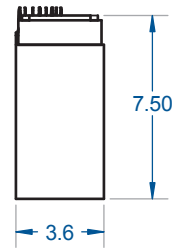
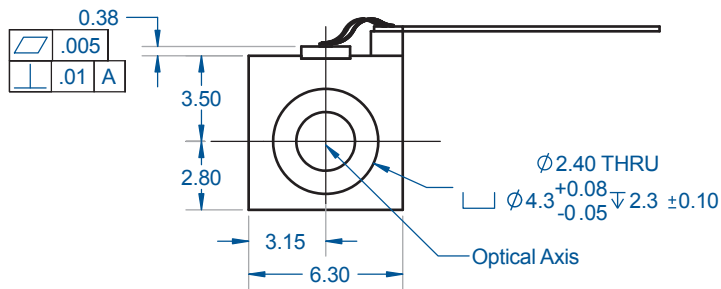
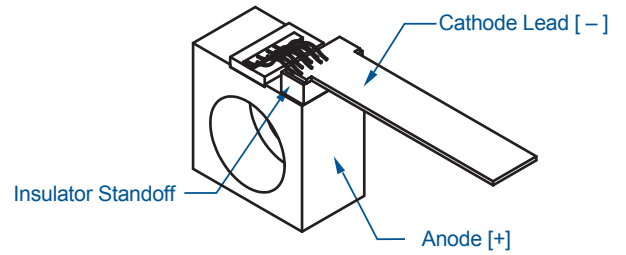
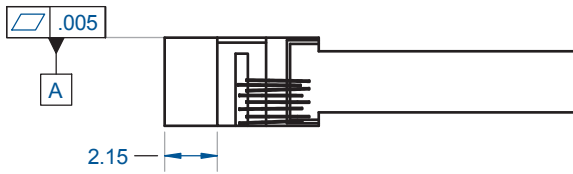

**BRIGHTNESS and POWER**  
*Breaking Performance Barriers through Semiconductor Laser Innovation*

**QPC Lasers, Inc.**

15632 Roxford Street • Sylmar, CA 91342 • Phone: +1 (818) 986-0000 • Fax: +1 (818) 698-0428

www.QPCLasers.com • email: info@QPCLasers.com